

Single level switches, side mounted LS-2050E, LS-52100E

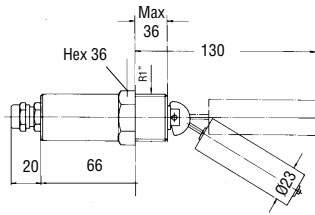

LS-2050E Brass/Buna N

General purpose materials designed to provide reliable service in oils and water.



LS-2050E S Steel

Ultimate strength; for pressure to 60 bar and temperatures to 150°C.

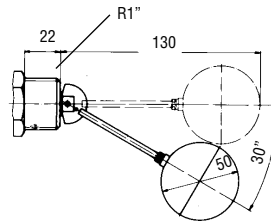

LS-52100E

Rugged, all-stainless steel unit offers a broad chemical compatibility at temperatures to 150°C.

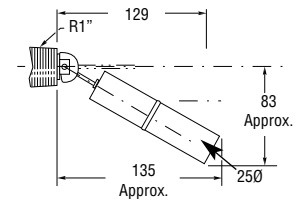

Specifications

	LS-2050(E) Brass/Buna N	LS-2050(E) S Steel / S Steel	LS-52100E
Materials	Brass	Stainless Steel	Stainless Steel
Stem/Mounting	Buna N	Stainless Steel	Stainless Steel
Operating pressure	10 bar	60 bar	35 bar
Temperature	80°C Water	+150°C	+ 150°C
-40°C to	110°C Oil		
Min. specific gravity of the liquid:	0.8	0.9	0.85
Type of reed switch:	SPDT 20 VA	SPDT 20 VA	SPDT 20 VA
Electrical connection:	Cable: 0.34 mm ² PVC	Cable: 0.5mm ² silicone	Cable: 0.5mm ² silicone
(Approx 1m long)	Terminal box	Terminal box	Terminal box
Mounting thread:	R1" Taper	R1" Taper	R1" Taper
Protection rating :	IP65	IP65	IP65
Weight: approx	300 g	350 g	300g

Order data

	LS-2050E Brass/Buna N	LS-2050E S Steel	LS-52100E S Steel
Cable	010 - 3465	010 - 3466	010 - 3461
Terminal Box	010 - 3463	010 - 3464	010 - 3462
Cable + Bellows		010 - 3468	
T. Box + Bellows		010 - 3469	

With Optional Bellows

Seals moving parts from debris and particulates that might impede shuttle movement. Available for all-stainless steel LS-2050E with 50mm float.

Temperature: 120°C max, Pressure; 1 bar max; Material; Buna N (Nitrile)

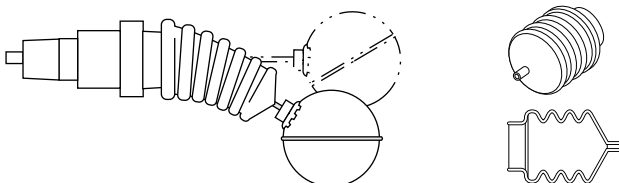

Switch with bellows. Bellows are not sold separately.