

MyProx Clone Inductive Proximity Sensors

Contents

Overview	1
Model Selection, Sensors	2
Model Selection, Compatible Connector Cables	3
Model Selection, Accessories	4
Wiring Diagrams	5
Specifications	6
Dimensions	6

The MyProx Clone sensor is the most versatile inductive proximity sensor available today. Beyond the capabilities of the MyProx Standard, the MyProx Clone includes advanced programmable characteristics such as adjustable output delay, speed detection and the ability to "clone" sensor configurations from over 4,800 competitive models.

Create your own sensor by customizing Output Type (Auto Configuration, PNP or NPN), Output Mode (Normally Open or Normally Closed), Sensing Range (down to the nearest tenth of a millimeter), Response Time and Noise Immunity. With the MyProx Programming Software, you can save your sensor configuration to a database and clone the configuration to other MyProx sensors.

The MyProx family of sensors utilizes an embedded microprocessor with an advanced sensing technology, enabling the MyProx to perform unique sensing functions at extended sensing ranges. These capabilities include Band Sensing, Position Sensing, Background Metal Rejection and more. Plus, you can program the MyProx to sense at a specific range.

Offering the utmost flexibility in both design and manufacturing, the MyProx can be pre-configured from the factory to your exact specifications or customized in-house using the MyProx Programming Software. Reduce your inventory and costly downtime with the innovative MyProx Clone.

One Proximity Sensor Designed to Replace All Others

Advanced Programmable Features

Micro-Connector Models Available

Highly Visible, Dual Color Output Status LED

Sense up to 3 Times as Far as Conventional Sensors

Vibration-Absorbing Potting Compound

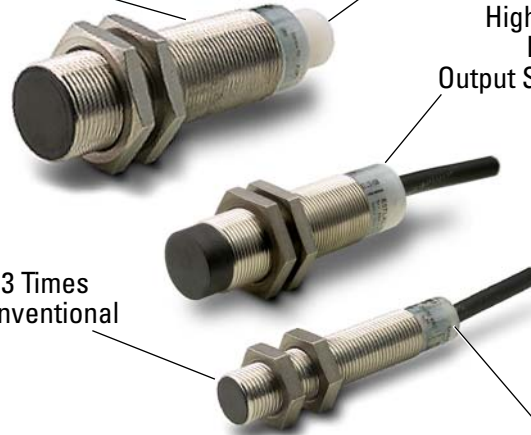

Product Features

- Replace thousands of sensors with the click of a button using the new MyProx Programming Software for Microsoft Windows® or Windows® Mobile devices
- Clone the MyProx to match the characteristics of more than 4,800 competitive models or custom configure the MyProx to match your specific application needs
- New Tray Programmer allows for "one touch" programming and batch programming of up to four sensors at a time
- New Remote Programming Device allows for mobile programming — no need to remove the sensor from its application
- Advanced programmable features such as dual outputs, output delay, speed detection, adjustable sensing range and more
- Reliably senses metal targets at up to three times the range of conventional shielded or unshielded inductive proximity sensors
- Field programmability reduces inventory and costly downtime
- Auto Configuration output allows for automatic detection of NPN or PNP
- Resistant to extreme temperature (-40°C) and high pressure washdown
- Withstands high electrical noise (up to 20 V/m)

Typical Applications

- Automotive
- Machine Tool
- Material Handling

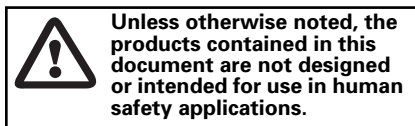

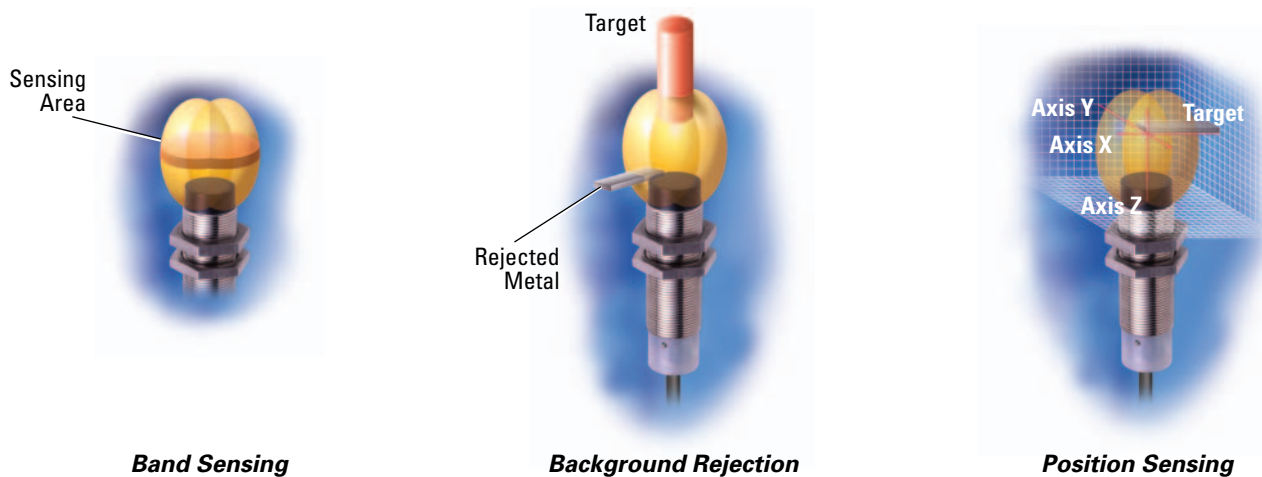
Band Sensing

The MyProx Clone senses within the band you determine.

Background Rejection

The MyProx Clone ignores metal objects in the side, fore- and background.

Position Sensing

The MyProx Clone detects position changes in multiple axes.

Model Selection — MyProx Clone

	Operating Voltage	Sensing Range	Shielding	Connection Type ①	Catalog Number	
					N.O. Output	N.C. Output

2-Wire Sensors

12 mm Diameter Standard Range Extended Range	20 – 132V AC	4 mm	Shielded	3-pin Micro AC Connector	E59-M12A105A01-A1 ☺	E59-M12A105A01-A2 ☺
				3-pin Micro AC Pigtail ②	E59-M12A105A01P-A1 ☺	E59-M12A105A01P-A2 ☺
				3-pin Mini AC Pigtail ②	E59-M12A105A01PB-A1 ☺	E59-M12A105A01PB-A2 ☺
				2-meter Cable	E59-M12A105C02-A1	E59-M12A105C02-A2
		10 mm	Unshielded	3-pin Micro AC Connector	E59-M12C110A01-A1 ☺	E59-M12C110A01-A2 ☺
				3-pin Micro AC Pigtail ②	E59-M12C110A01P-A1 ☺	E59-M12C110A01P-A2 ☺
				3-pin Mini AC Pigtail ②	E59-M12C110A01PB-A1 ☺	E59-M12C110A01PB-A2 ☺
				2-meter Cable	E59-M12C110C02-A1	E59-M12C110C02-A2
18 mm Diameter Standard Range Extended Range	20 – 132V AC	8 mm	Shielded	3-pin Micro AC Connector	E59-M18A109A01-A1 ☺	E59-M18A109A01-A2 ☺
				3-pin Micro AC Pigtail ②	E59-M18A109A01P-A1 ☺	E59-M18A109A01P-A2 ☺
				3-pin Mini AC Pigtail ②	E59-M18A109A01PB-A1 ☺	E59-M18A109A01PB-A2 ☺
				2-meter Cable	E59-M18A109C02-A1	E59-M18A109C02-A2
		18 mm	Unshielded	3-pin Micro AC Connector	E59-M18C118A01-A1 ☺	E59-M18C118A01-A2 ☺
				3-pin Micro AC Pigtail ②	E59-M18C118A01P-A1 ☺	E59-M18C118A01P-A2 ☺
				3-pin Mini AC Pigtail ②	E59-M18C118A01PB-A1 ☺	E59-M18C118A01PB-A2 ☺
				2-meter Cable	E59-M18C118C02-A1	E59-M18C118C02-A2
30 mm Diameter Standard Range Extended Range	20 – 132V AC	15 mm	Shielded	3-pin Micro AC Connector	E59-M30A115A01-A1 ☺	E59-M30A115A01-A2 ☺
				3-pin Micro AC Pigtail ②	E59-M30A115A01P-A1 ☺	E59-M30A115A01P-A2 ☺
				3-pin Mini AC Pigtail ②	E59-M30A115A01PB-A1 ☺	E59-M30A115A01PB-A2 ☺
				2-meter Cable	E59-M30A115C02-A1	E59-M30A115C02-A2
		29 mm	Unshielded	3-pin Micro AC Connector	E59-M30C129A01-A1 ☺	E59-M30C129A01-A2 ☺
				3-pin Micro AC Pigtail ②	E59-M30C129A01P-A1 ☺	E59-M30C129A01P-A2 ☺
				3-pin Mini AC Pigtail ②	E59-M30C129A01PB-A1 ☺	E59-M30C129A01PB-A2 ☺
				2-meter Cable	E59-M30C129C02-A1	E59-M30C129C02-A2

① For cable lengths longer than 2 meters, substitute the length in meters, e.g. E59-M18A109C05-A1 (5 meters).

② 12-inch cable is standard on all pigtail connection options.

☺ See listing of compatible connector cables on **Page 3**.

Model Selection — MyProx Clone (Continued)

	Operating Voltage	Sensing Range	Shielding	Connection Type ^①	Catalog Number	
					N.O. Output	N.C. Output
3-Wire Sensors						
12 mm Diameter Standard Range Extended Range	6 – 48V DC	4 mm	Shielded	4-pin Micro DC Connector	E59-M12A105D01-D1 [⊕] ^③	E59-M12A105D01-D2 [⊕]
				4-pin Micro DC Pigtail ^②	E59-M12A105D01P-D1 [⊕]	E59-M12A105D01P-D2 [⊕]
				2-meter Cable	E59-M12A105C02-D1 ^③	E59-M12A105C02-D2
		10 mm	Unshielded	4-pin Micro DC Connector	E59-M12C110D01-D1 [⊕] ^③	E59-M12C110D01-D2 [⊕]
				4-pin Micro DC Pigtail ^②	E59-M12C110D01P-D1 [⊕]	E59-M12C110D01P-D2 [⊕]
				2-meter Cable	E59-M12C110C02-D1 ^③	E59-M12C110C02-D2
18 mm Diameter Standard Range Extended Range	6 – 48V DC	8 mm	Shielded	4-pin Micro DC Connector	E59-M18A108D01-D1 [⊕] ^③	E59-M18A108D01-D2 [⊕]
				4-pin Micro DC Pigtail ^②	E59-M18A108D01P-D1 [⊕]	E59-M18A108D01P-D2 [⊕]
				2-meter Cable	E59-M18A108C02-D1 ^③	E59-M18A108C02-D2
		18 mm	Unshielded	4-pin Micro DC Connector	E59-M18C116D01-D1 [⊕] ^③	E59-M18C116D01-D2 [⊕]
				4-pin Micro DC Pigtail ^②	E59-M18C116D01P-D1 [⊕]	E59-M18C116D01P-D2 [⊕]
				2-meter Cable	E59-M18C116C02-D1 ^③	E59-M18C116C02-D2
30 mm Diameter Standard Range Extended Range	6 – 48V DC	15 mm	Shielded	4-pin Micro DC Connector	E59-M30A115D01-D1 [⊕] ^③	E59-M30A115D01-D2 [⊕]
				4-pin Micro DC Pigtail ^②	E59-M30A115D01P-D1 [⊕]	E59-M30A115D01P-D2 [⊕]
				2-meter Cable	E59-M30A115C02-D1 ^③	E59-M30A115C02-D2
		29 mm	Unshielded	4-pin Micro DC Connector	E59-M30C129D01-D1 [⊕] ^③	E59-M30C129D01-D2 [⊕]
				4-pin Micro DC Pigtail ^②	E59-M30C129D01P-D1 [⊕]	E59-M30C129D01P-D2 [⊕]
				2-meter Cable	E59-M30C129C02-D1 ^③	E59-M30C129C02-D2

^① For cable lengths longer than 2 meters, substitute the length in meters, e.g. E59-M18A108C05-D1 (5 meters).

^② 12-inch cable is standard on all pigtail connection options.



^③ Dual outputs available on these models. Specify dual PNP or dual NPN by adding **PP** or **NN** to the end of the Catalog Number. For example, E59-M30C129D01-D1**PP** references a PNP dual channel MyProx sensor.

[⊕] See listing of compatible connector cables below.

Model Selection — Compatible Connector Cables ^④

	Voltage Style	Number of Pins	Gauge	Length	Catalog Number			Pin Configuration/Wire Colors (Face View Female Shown)
					PVC Jacket	PUR Jacket	IRR PUR Jacket	
Standard Cables — Micro Style								
Micro Style Straight Female 	AC	3-pin 3-wire	22 AWG	2m (6 feet)	CSAS3F3CY2202	CSAS3F3RY2202	—	 1-Green 2-Red/Black 3-Red/White
	DC	4-pin 4-wire	22 AWG	2m (6 feet)	CSDS4A4CY2202	CSDS4A4RY2202	CSDS4A4IO2202	 1-Brown 2-White 3-Blue 4-Black
Standard Cables — Mini Style								
Mini Style Straight Female Current Rating @ 600V 3-pin: 13A	—	3-pin	16 AWG	2m (6 feet)	CSMS3F3CY1602		—	 1-Green 2-Black 3-White

Model Selection — Accessories

	Description	Catalog Number
	Magnetic remote programmer required for programming	E59RP1
	Step by step programming Software V 2.6	E59SW1

Wiring Diagrams (Pin numbers are for reference, rely on pin location when wiring)

Operating Voltage	Output	Cable Models	Connector Models (Face View Male Shown)	
			Micro	Mini
2-Wire Sensors				
20 – 132V AC	N.O. and N.C.			
3-Wire Sensors				
6 – 48V DC	N.O. and N.C. (NPN)			—
	N.O. and N.C. (PNP)			—
4-Wire Dual Output Sensors				
6 – 48V DC	N.O. and N.C. (NPN)			—
	N.O. and N.C. (PNP)			—

① Note: Pin numbers 2 and 4 are internally jumpered together. Either pin may be used.

Specifications — MyProx Clone

Description	2-Wire Sensors	3-Wire Sensors
Input Voltage	20 – 132V AC	6 – 48V DC
Load Current	12 mm: 5 – 300mA, 200mA > 50°C	≤500 mA @ 6 – 30V DC; ≤300 mA @ 32 – 48V DC
Leakage Current	≤1.7 mA @ 0°C, 2.0 mA @ -40°C	≤150 μA
Voltage Drop	<5V AC	≤2.5V DC
Burden Current	—	≤15 mA
Protection	None	Auto Reset
Switching Hysteresis	< 15% Rated Sensing Distance	
Repeat Accuracy	Shielded models: < 1% Sensing Distance; Unshielded models: < 3% Sensing Distance	
Surge Capacity	3A/30 ms	—
Temperature Range	-40° to 70°C (-40 to 158 F)	
Material of Construction	303 Stainless steel; End bells: Polycarbonate; Face caps: Ryton [®] ; Cable: AWM Style 20387 (PVC) ^③	
Vibration and Shock	Vibration: 10 to 55 Hz, 1 mm Amplitude, IEC 60068-2-6; Shock: 30g, 11 mS per IEC 68-2-27	
Indicator LED	360° viewable LED	
Enclosure Ratings	IP67(NEMA 4, 4X, 6, 6P, 12 and 13) ^④	

Response Time ^①	2-Wire Sensors	3-Wire Sensors					
	All 2-Wire Models	Shielded			Unshielded		
		12 mm	18 mm	30 mm	12 mm	18 mm	30 mm
Factory Default Mode	Shipped in “Side by Side Mode” by default (20 V/m)	580 Hz (10 V/m)	390 Hz (10 V/m)	240 Hz (10 V/m)	300 Hz (10 V/m)	150 Hz (10 V/m)	145 Hz (10 V/m)
Side by Side ^②	30 Hz (10 V/m)	50 Hz (20 V/m)					
High Noise Immunity Mode	10 Hz (>20 V/m)	10 Hz (>20 V/m)					

^① MyProx sensors may be programmed to perform in Side by Side or High Noise immunity applications using the MyProx Remote Programmer (E59RP1) & Programming Software (E59SW1).

^② Use the Side by Side response time parameter when using the MyProx Programming Station (E59TP1), Remote Programmer (E59RP1) and Programming Software (E59SW1).

^③ Ryton[®] is a registered trademark of Phillips Chemical (division of Phillips Petroleum).

^④ Our products conform to NEMA tests as indicated, however, some severe washdown applications can exceed these NEMA test specifications.

Approximate Dimensions — MyProx Clone in Inches (mm)

Cable Models

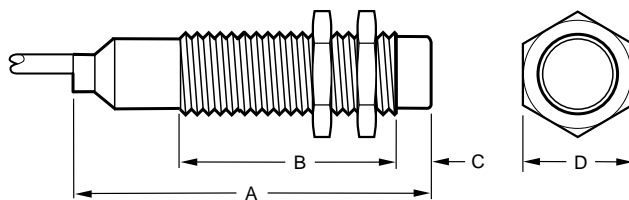

Micro-Connector Models

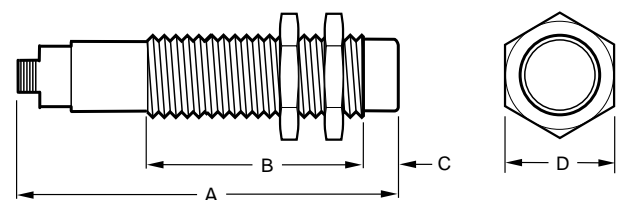

Cable Models

Size	Shielding	A	B	C	D
12 mm	Shielded	2.46 (62.4)	1.98 (50.3)	0.02 (0.5)	0.67 (17)
	Unshielded	2.46 (62.4)	1.64 (41.6)	0.36 (9)	0.67 (17)
18 mm	Shielded	2.54 (64.5)	2.00 (50.9)	0.02 (0.5)	0.94 (24)
	Unshielded	2.54 (64.5)	1.47 (37.4)	0.55 (14)	0.94 (24)
30 mm	Shielded	2.74 (69.6)	2.13 (54.1)	0.03 (0.75)	1.41 (36)
	Unshielded	2.74 (69.6)	1.41 (35.8)	0.75 (19)	1.41 (36)

Micro-Connector Models

Size	Shielding	A	B	C	D
12 mm	Shielded	2.71 (68.7)	1.98 (50.3)	0.02 (0.5)	0.67 (17)
	Unshielded	2.71 (68.7)	1.64 (41.6)	0.36 (9)	0.67 (17)
18 mm	Shielded	2.73 (69.3)	2.00 (50.9)	0.02 (0.5)	0.94 (24)
	Unshielded	2.73 (69.3)	1.47 (37.4)	0.55 (14)	0.94 (24)
30 mm	Shielded	2.92 (74.1)	2.13 (54.1)	0.03 (0.75)	1.41 (36)
	Unshielded	2.92 (74.1)	1.41 (35.8)	0.75 (19)	1.41 (36)